

THE ASPIRE

Studio home-on-wheels

The Aspire is a 6m trailer-integrated studio home. It's towable, registrable and expands to double it's size once setup. Featuring an integrated deck, breakfast bar and large sliding door entry

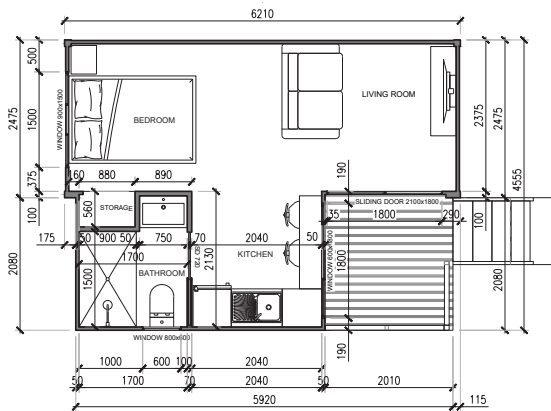

DIMENSIONS

Length of house	6m
Towing length	7.92m
Expanded width	4.5m
Width including deck	4.5m
Weight (approx)	3200kg
Height	3.6m

STANDARD INCLUSIONS

- Walls 50mm, roof 100mm insulated panel 0.6 mm metal skin
- Sliding door entrance with security screen and large windows fitted with fly screens
- Kitchenette with built-in breakfast bar
- Air conditioning
- Bathroom with vanity, shower and toilet suite.
- Plumbing including instantaneous 20litre gas hot water system
- Complete electrical wiring for connection to 15 amp lead including light fixtures, 6 x double GPs and smoke detector
- Staircase with handrail and undercover deck
- Hybrid floating floor
- Bedroom with built-in storage and wardrobe.

OPTIONAL UPGRADES

- **Light & Airy colour palette:**
Includes wallpaper feature wall, internal cladding, backsplash, custom cabinetry, brushed gold tapware.
- **Dark & Moody colour palette:**
Includes wallpaper feature wall, internal cladding, backsplash, custom cabinetry, brushed nickel tapware.
- **Off-grid solutions:**
Including gas appliances, solar panels, eco toilet and water management systems.
- **Internal & External upgrades:**
Can include custom paint, cladding, wallpaper, additional decking, upgraded appliances such as dishwasher, air conditioning units, fire places, freestanding bath and more.